

College of Saint Benedict and Saint John's University

DigitalCommons@CSB/SJU

Archives History Lessons

Archives

2014

Saint Benedict's Master Plans (1960s-1990s)

Peggy L. Roske

College of Saint Benedict/Saint John's University, proske@csbsju.edu

Follow this and additional works at: https://digitalcommons.csbsju.edu/archives_history_lessons

Recommended Citation

Roske, Peggy L., "Saint Benedict's Master Plans (1960s-1990s)" (2014). *Archives History Lessons*. 51.
https://digitalcommons.csbsju.edu/archives_history_lessons/51

This Presentation is brought to you for free and open access by DigitalCommons@CSB/SJU. It has been accepted for inclusion in Archives History Lessons by an authorized administrator of DigitalCommons@CSB/SJU. For more information, please contact digitalcommons@csbsju.edu.

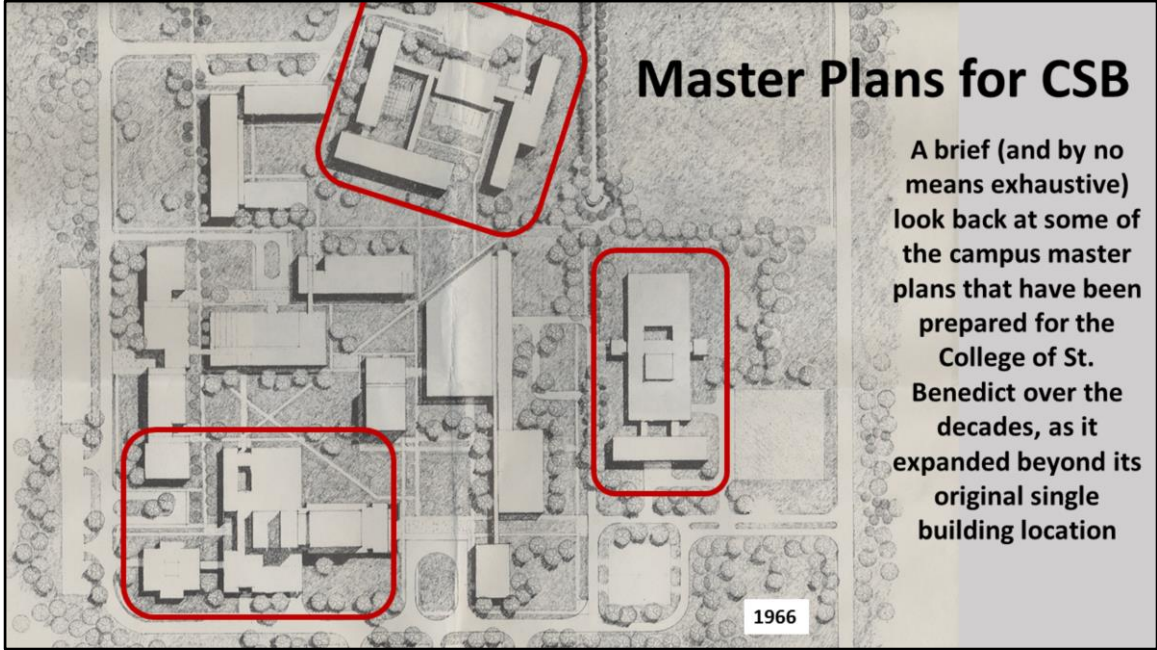

Master Plans for CSB

A brief (and by no means exhaustive) look back at some of the campus master plans that have been prepared for the College of St. Benedict over the decades, as it expanded beyond its original single building location

1966

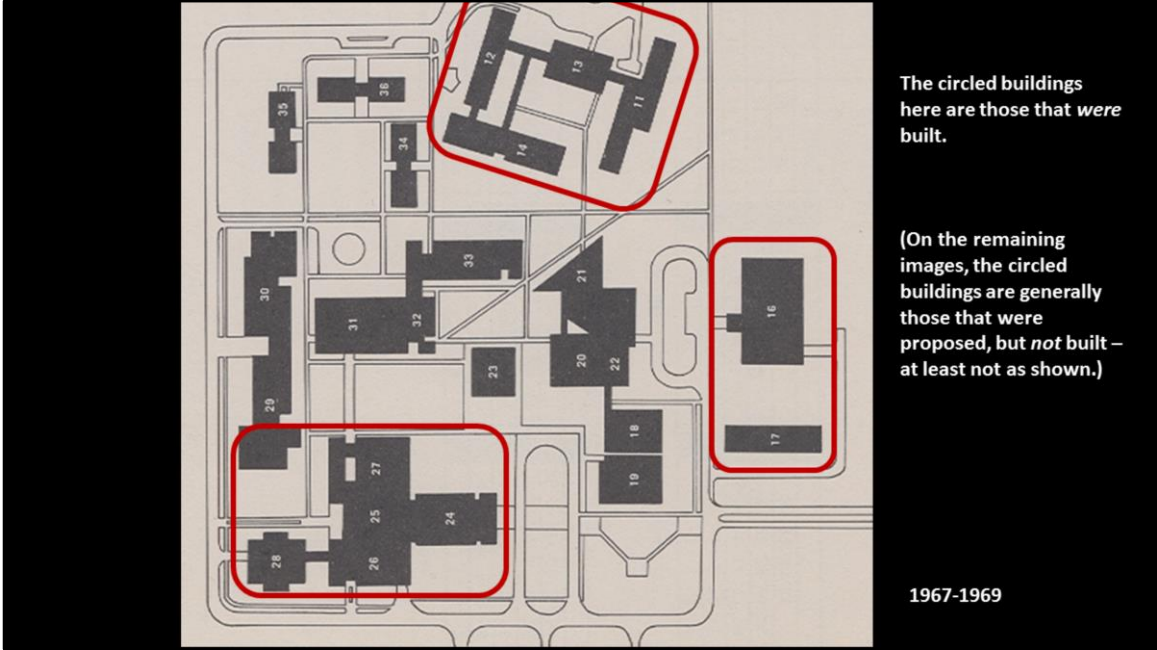

The circled buildings here are those that *were* built.

(On the remaining images, the circled buildings are generally those that were proposed, but *not* built – at least not as shown.)

1967-1969

1967-69 Campus Map

SEVEN VOLUNTEERS AND THE MASTER PLAN

"The volunteer is going through an evolution. She used to be an upper-middle-class woman of 40 and older who put her talents to work for charity after her children were grown. Now she's a teenager, a mother, a working woman, retired professional person or from any walk of life. She cares about the welfare of her fellow man."

Mrs. Rex Roupe, national chairwoman of the Goodwill Industries Auxiliary volunteers

"We simply cannot drift. What are our goals?" Dr. Idzerda has often asked since his inauguration in 1968.

"You cannot ask people to support your college unless you know who you are and what you're aiming at, and that calls for a long-range plan," said Jay Gerber, educational and development consultant to CSB, representing Gonsler, Gerber, Tinker, Stuhr of Chicago.

The Plan didn't just happen. Since December, 1969, Sister Firmin Escher, academic dean, has been reading, preparing, and planning. Beginning in July, the Master Planning Committee (involving 12 people), representing five Task Teams (involving 50 people), has met weekly. The five areas are:

- I. Administration, Organization, Faculty
- II. Students and Student Life
- III. Instructional Programs and Library
- IV. Finance, Facilities, Physical Plant
- V. Development, Public Service, Research

In turn, each of the Task Teams involve other faculty, students, parents, and alumnae (around 200) to conduct interviews, gather data, and make recommendations.

Expectations from this long-range planning are many: clarification of the direction CSB is going; an increase in efficiency of opera-

How much this Master Plan means to the College of Saint Benedict may be seen by meeting seven volunteers, representing students, parents, and alumnae. It would be a mistake to call any one of them a "typical" volunteer, for each makes a unique contribution to planning.

PARENTS

Frank and Dolores Grundman



"The Master Planning Committee shows that Saint Ben's does care about meeting present and future students' needs, that it won't stagnate," Nancy Goede '72 emphasized.

"My highest hope for the Master Plan is that even more students get involved with evaluating and planning," Nancy said. "And the Master Plan should include cooperation with SJU.

1970 Winter St. Benedict's, p. 3-5

1970 Winter St. Benedict's p. 3 and p. 5

<http://cdm.csbsju.edu/cdm/ref/collection/CSBArchives/id/749>

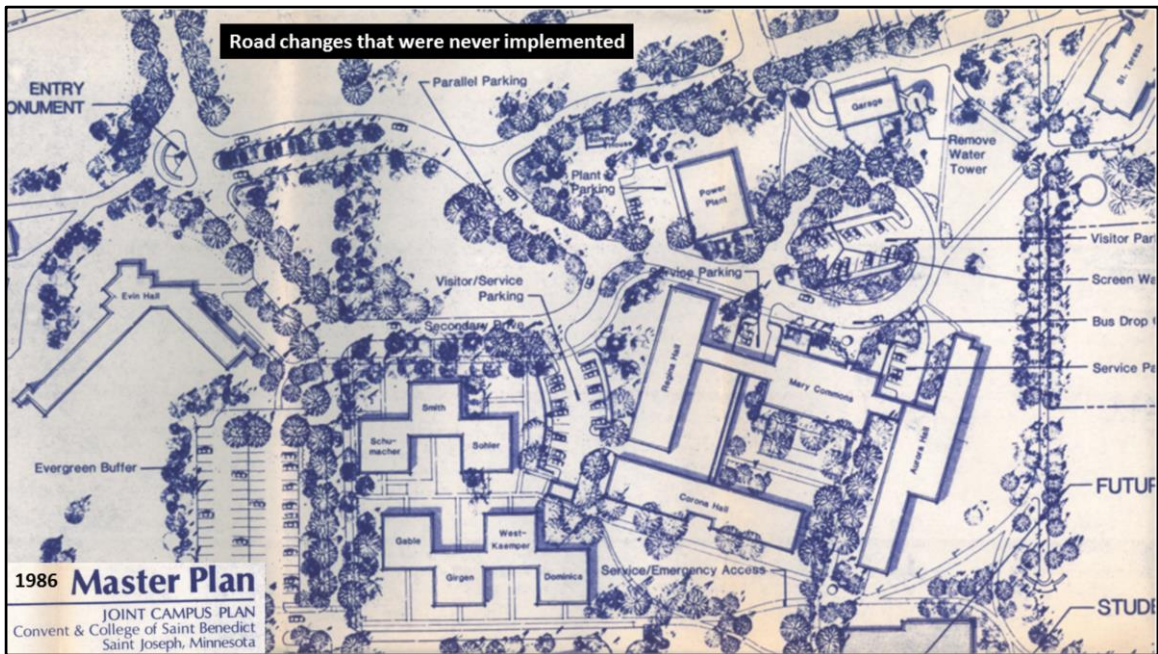

1986

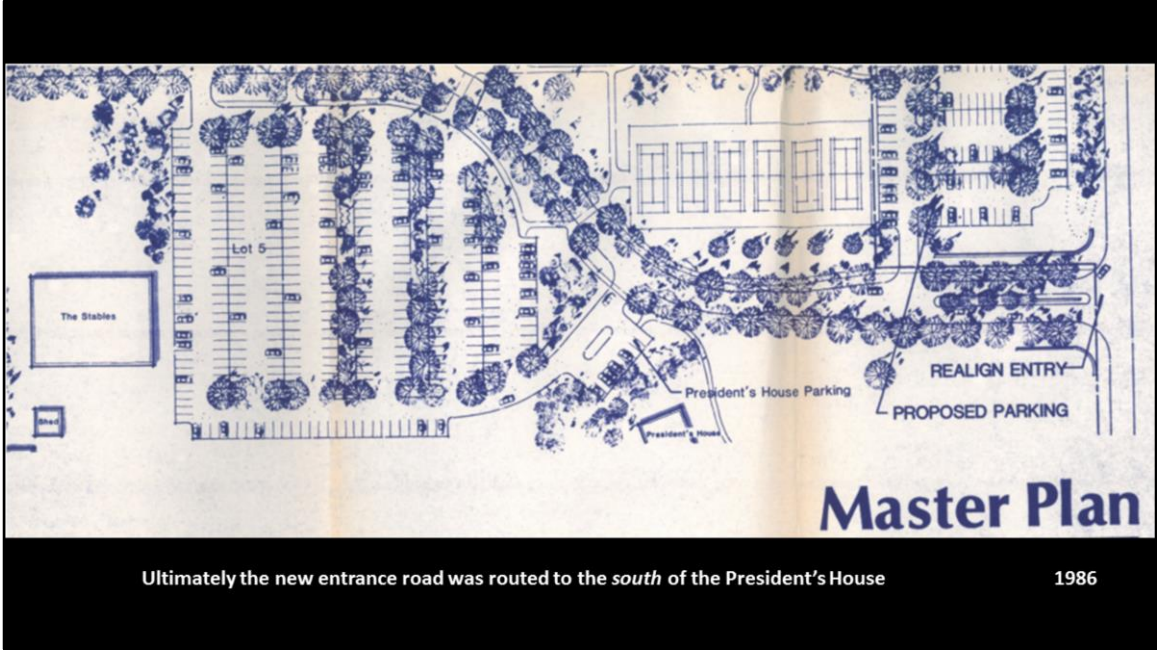

1986

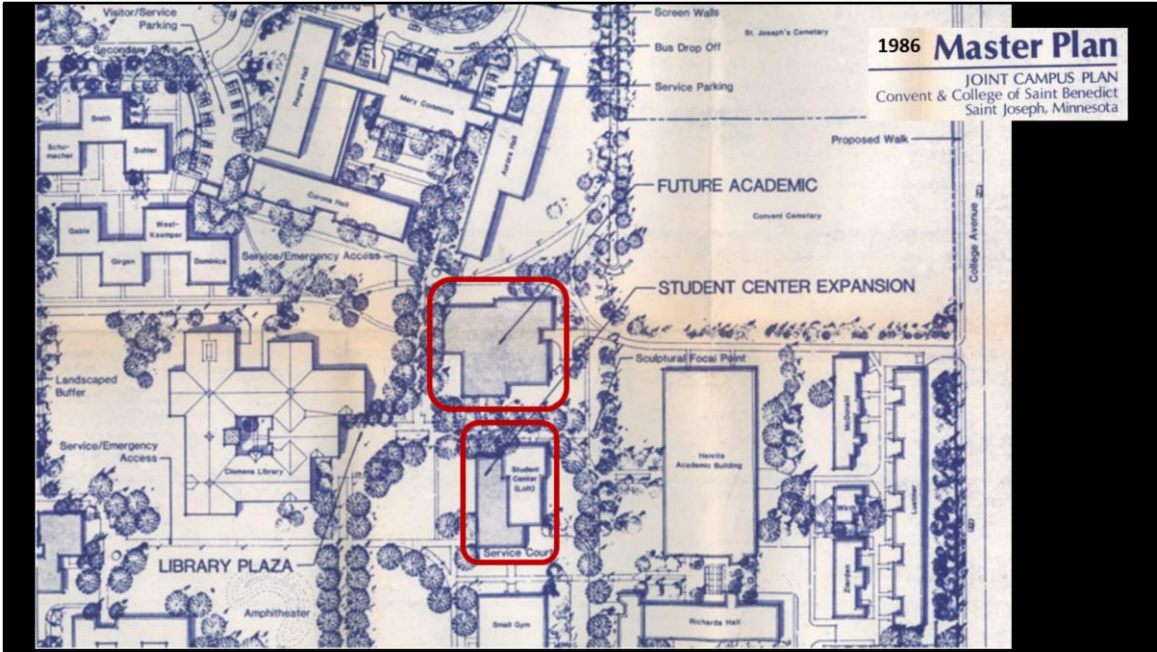

1986

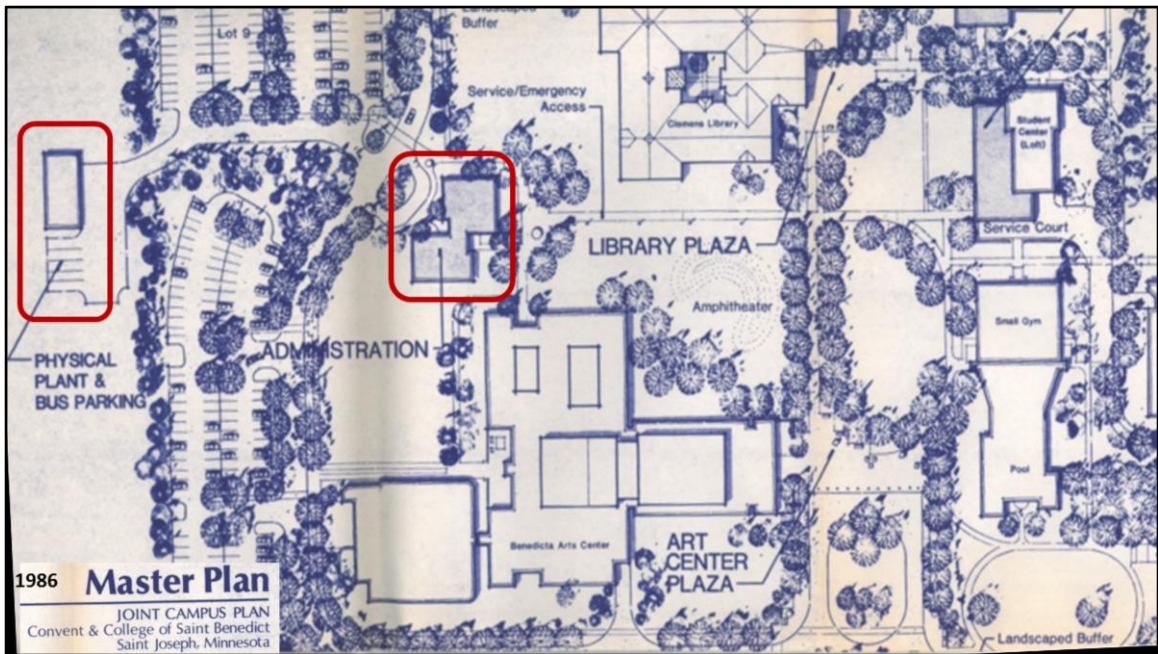

1986

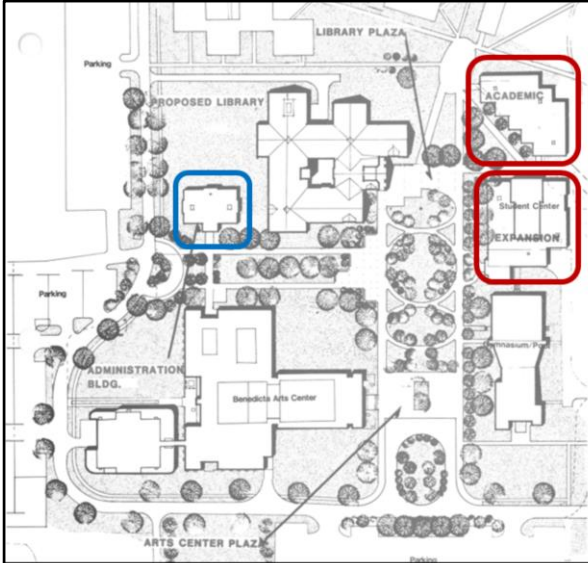

Concept 'A'
College Mall Design
 JOINT CAMPUS PLAN
 Page 36

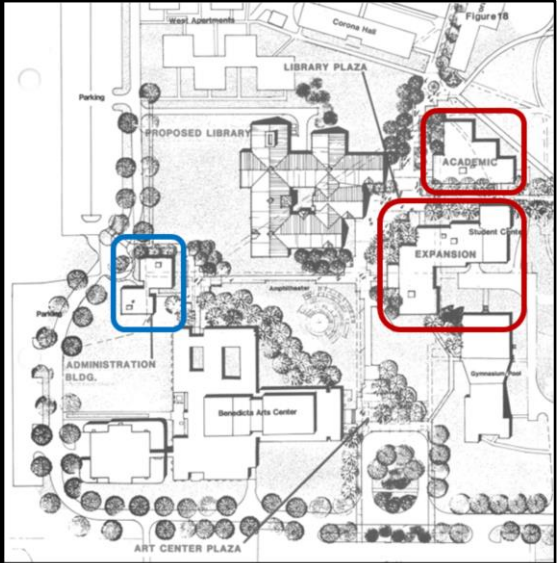

Concept 'B'
College Mall Design
 JOINT CAMPUS PLAN
 Page 36

1986

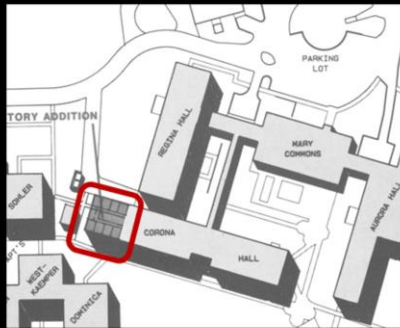

Scheme 'A'
Dormitory Expansion
 JOINT CAMPUS PLAN
 Page 40

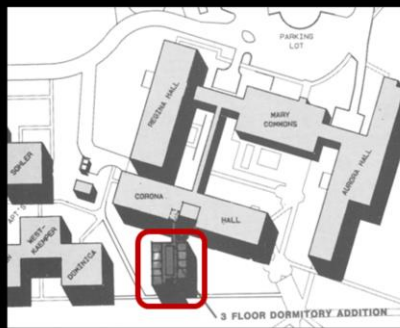

Scheme 'B'
Dormitory Expansion
 JOINT CAMPUS PLAN
 Page 41

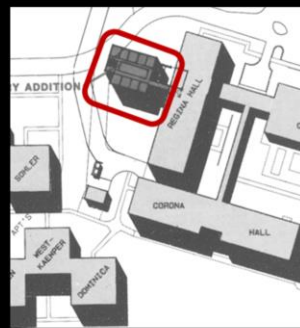

Scheme 'C'
Dormitory Expansion
 JOINT CAMPUS PLAN
 Page 43

Dorm expansions that weren't built...at least not yet.

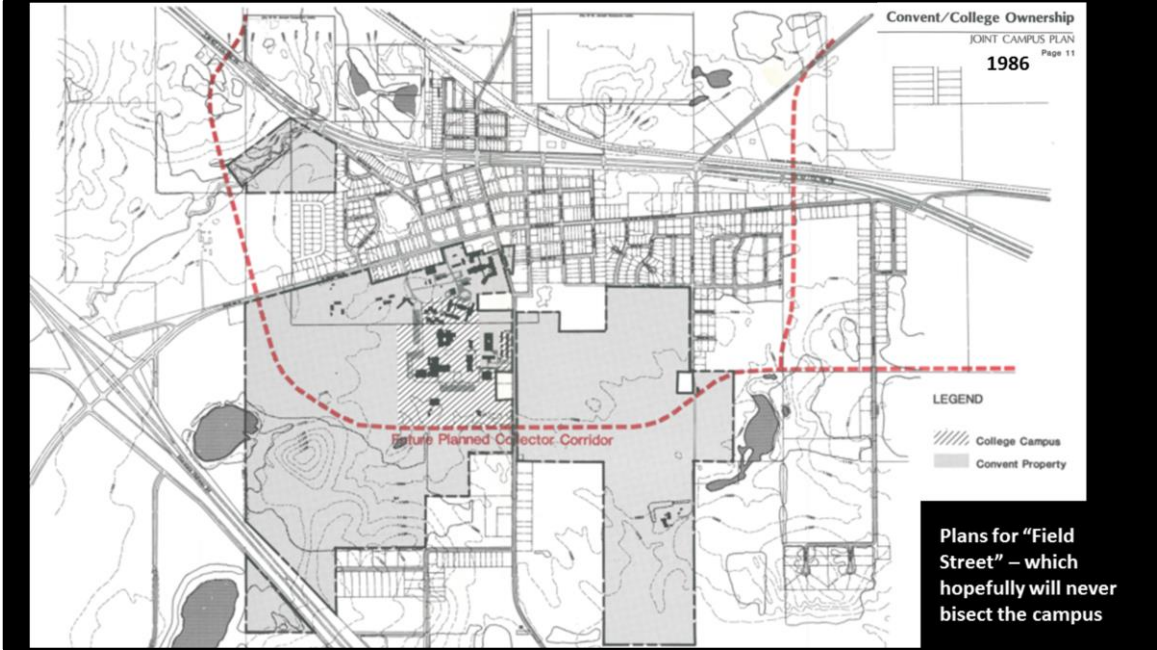

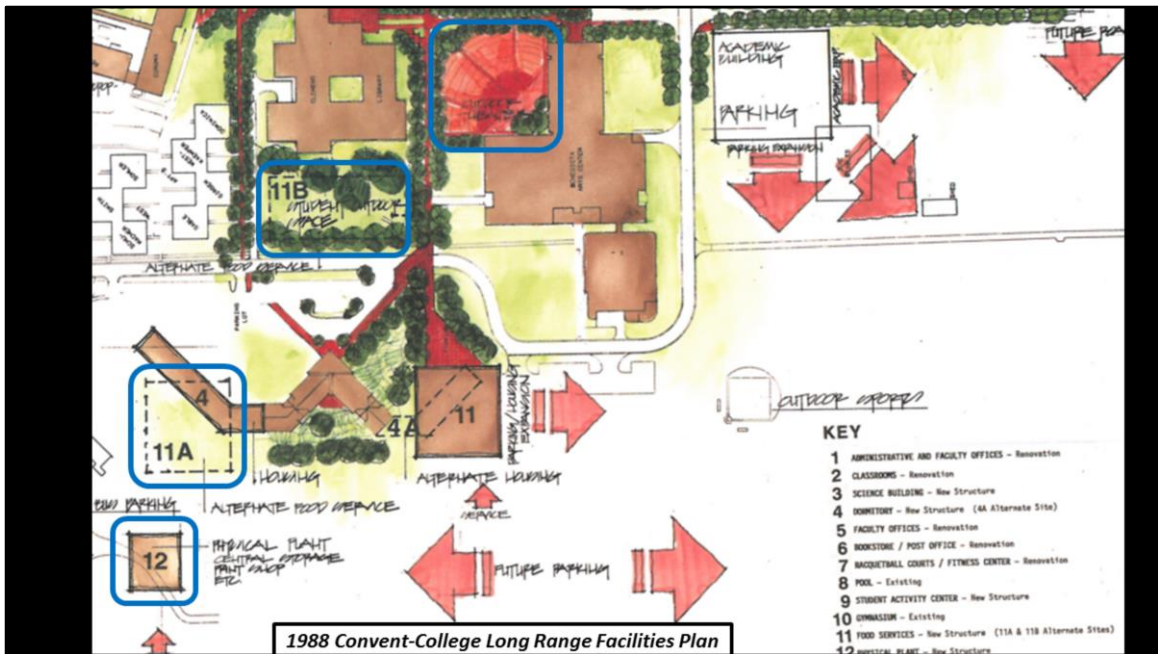

1988 Revised Master Plans Ideas - Convent-College, 3-8-1988, College of St. Benedict Long Range Facilities Plans Colored

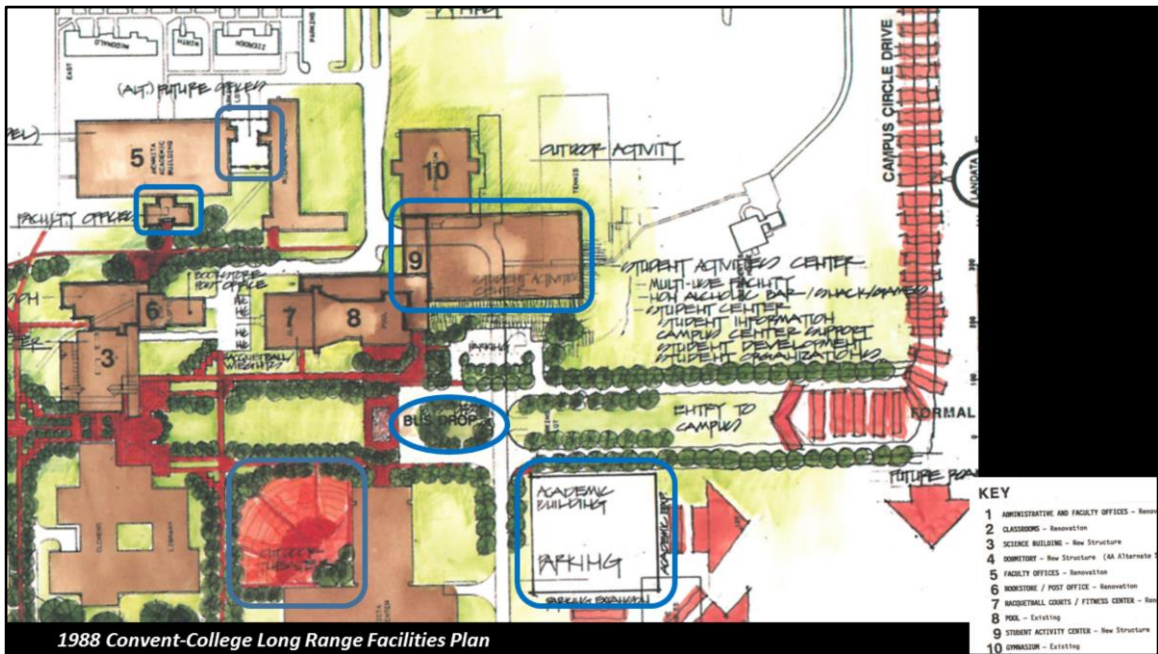

1988 Revised Master Plans Ideas - Convent-College, 3-8-1988, College of St. Benedict Long Range Facilities Plan

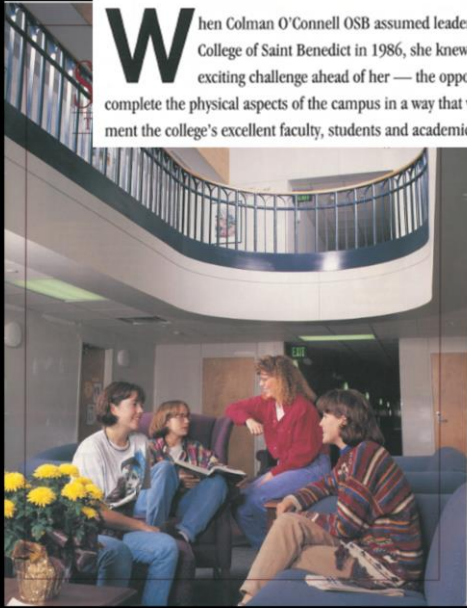

When Colman O'Connell OSB assumed leadership of the College of Saint Benedict in 1986, she knew that she had an exciting challenge ahead of her — the opportunity to complete the physical aspects of the campus in a way that would complement the college's excellent faculty, students and academic programs.

A Master Plan is Born

To guide the growth, O'Connell charged a campus committee and our firm, Grooters Leapoldt Tideman Architects (GLTA) of St. Cloud, with not only responding to immediate student needs, but, even more importantly, with creating a comprehensive master plan for the college.

Our master plan also created a new landmark. The public mall area on the south side of the campus is designed to serve as the main public entrance to campus and as a new landmark for the most public areas on campus. "Once the new entrance is done," promises O'Connell, "visitors to the campus will know that they have arrived at a quality institution."

Extending a Welcome

The Rule of Saint Benedict instructs followers to be hospitable. In turn, the college's master plan calls for the campus to welcome community members and strangers alike.

St. Benedict's Today Fall 1994

St. Benedict's Today Fall 1994

<http://cdm.csbsju.edu/cdm/ref/collection/CSBArchives/id/5062> cover

<http://cdm.csbsju.edu/cdm/ref/collection/CSBArchives/id/5078> quotes p. 15

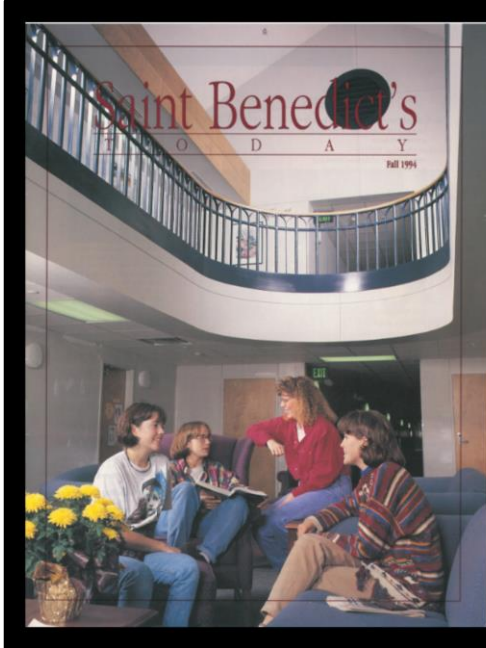

Looking Toward the Future

Many of the specific objectives set forth in the nearly decade-old master plan have been achieved, according to O'Connell. That doesn't mean there will be no more buildings or renovations, she says.

"But what it does mean," she continues, "is that we can focus our development efforts on growing our endowment so that we can keep CSB affordable while continually enhancing the student experience."

Achieving the master plan has also brought a strong and positive reaction from alumnae, testifies O'Connell. "For seven years, I have been speaking to alumnae at the Reunion each June and when I get to the part in my talk when I describe CSB as being one of the best liberal arts, residential Catholic colleges in the country, I would see their eyes start to glaze over. They couldn't believe we were first class because the place didn't look first class.

"This past June, I saw belief in their eyes," she recalls. "Today CSB looks like what it always was — a first-class college. Alumnae, other college presidents, friends — anyone who comes to campus now knows it." □

St. Benedict's Today Fall 1994

<http://cdm.csbsju.edu/cdm/ref/collection/CSBArchives/id/5062> cover

<http://cdm.csbsju.edu/cdm/ref/collection/CSBArchives/id/5079> quotes p. 16

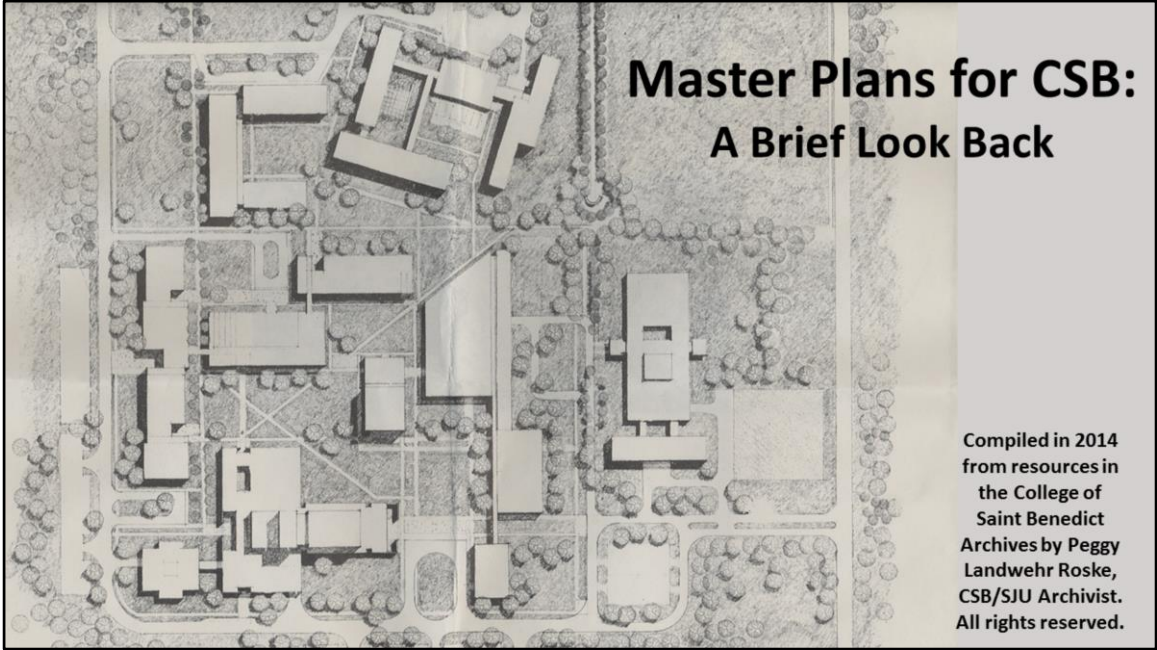

Master Plans for CSB: A Brief Look Back

Compiled in 2014
from resources in
the College of
Saint Benedict
Archives by Peggy
Landwehr Roske,
CSB/SJU Archivist.
All rights reserved.

1966