

College of Saint Benedict and Saint John's University

DigitalCommons@CSB/SJU

---

Archives History Lessons

Archives

---

2012

## Saint Benedict's Buildings, Part 3

Peggy L. Roske

College of Saint Benedict/Saint John's University, proske@csbsju.edu

Follow this and additional works at: [https://digitalcommons.csbsju.edu/archives\\_history\\_lessons](https://digitalcommons.csbsju.edu/archives_history_lessons)

---

### Recommended Citation

Roske, Peggy L., "Saint Benedict's Buildings, Part 3" (2012). *Archives History Lessons*. 52.  
[https://digitalcommons.csbsju.edu/archives\\_history\\_lessons/52](https://digitalcommons.csbsju.edu/archives_history_lessons/52)

This Presentation is brought to you for free and open access by DigitalCommons@CSB/SJU. It has been accepted for inclusion in Archives History Lessons by an authorized administrator of DigitalCommons@CSB/SJU. For more information, please contact [digitalcommons@csbsju.edu](mailto:digitalcommons@csbsju.edu).

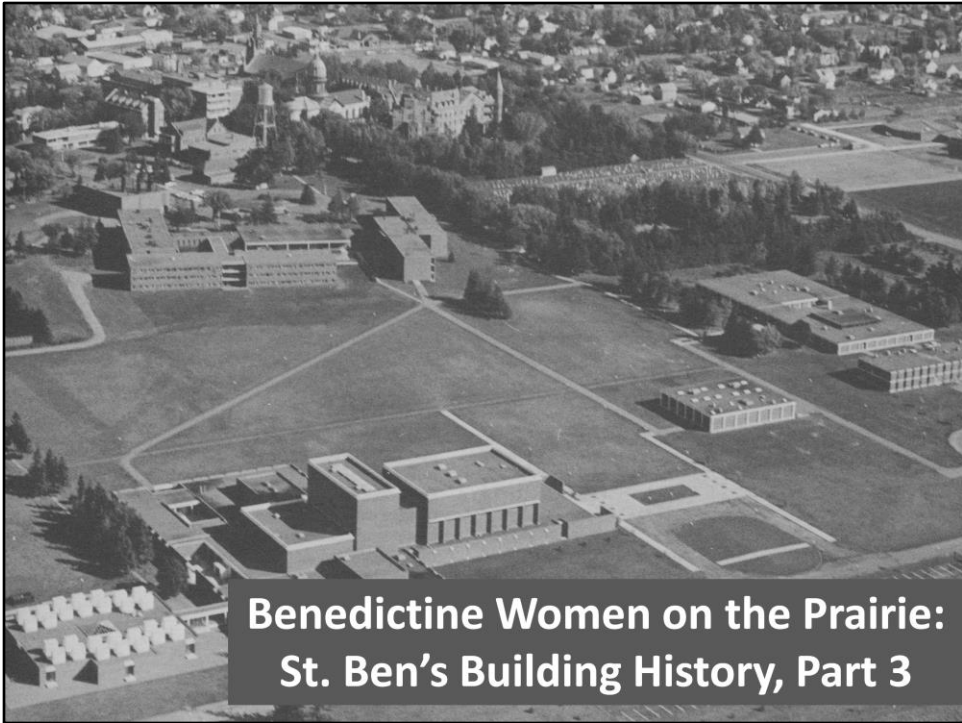

**Benedictine Women on the Prairie:  
St. Ben's Building History, Part 3**

Benedictine Women on the Prairie: St. Ben's Building History, Part 3



Where we left off: CSB campus in 1970  
1971-72 Catalog: CSB aerial photo ca. 1970 looking NE  
<http://cdm.csbsju.edu/cdm/ref/collection/CSBArchives/id/1909>



**Idzerda House**

...but first known as the Davidson House, designed for a big family.

There's a sad story about it: one of the children, a 4-year old, fell off the balcony of the house and died.

Backtracking a bit – more on the Idzerda House's story



Father Walbert Kalnowski, OSB, and Dr. John Lange attended a meeting of the American Mathematical society in Chicago, April 12-14. A special feature of the meeting was a symposium on experimental arithmetic to examine ways in which arithmetic potential of modern high speed computing equipment can furnish experience which sheds light on outstanding mathematical problems. They also examined the computing center at Marquette university.

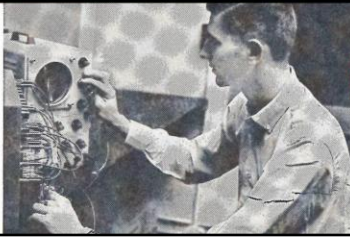

Minnesota  
at your residence,  
St. John's Alumni Office.

## Deaths

The following persons have died during the past month. Your prayers are requested.

Mr. Louis Beachemin's mother, Hilda, died March 28 of a heart attack.

Mr. Paul Lauretta's father, Salvatore, died April 9 after a long illness.

Dr. Sylvester Theisen's father, Math, was struck and killed by an automobile.

Dr. William Davidson's son, Benedict, age four, died April 13 of injuries resulting from a fall.

St. John's... at St. Martin in 1942 when re-  
He was invested by the... until 1942 when he  
Alcuin Deutsch, OSB, on June... was named pastor at Beaulieu.  
In 1944 he was named pastor of  
St. John the Baptist church at  
Collegeville. Father Cyril returned  
to St. Martin in 1947 and served  
there as pastor until the time of  
his death, Saturday morning.

**Oberembt Wins  
Scholarship**

Dr. Davidson built the house, but left a few years after the family tragedy  
1962 May 11 *Record* p. 4  
<http://cdm.csbsju.edu/cdm/ref/collection/CSBArchNews/id/33278/show/33277>



4-year old Benedict Davidson's headstone, carved by Colledgeville artist Joe O'Connell





CSB in 1972: some things have been added since 1970!

1972 aerial photo of CSB

<http://cdm.csbsju.edu/cdm/ref/collection/CSBArchives/id/13>

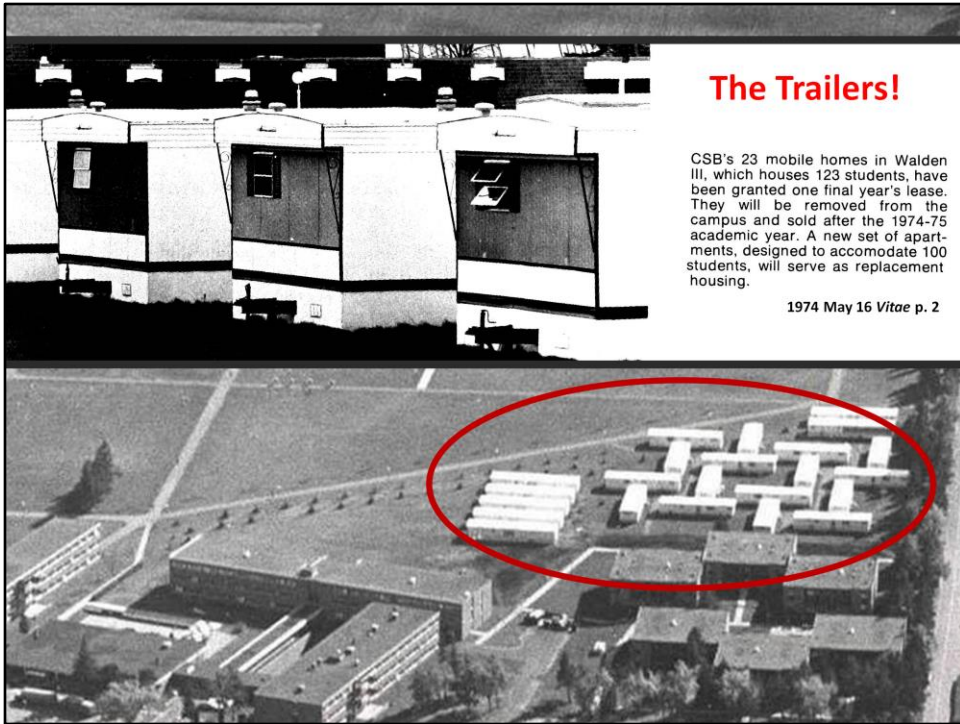

1. To solve a housing crunch: Mobile home trailers house students from 1971-1975

1974 May 16 *Vitae* p. 2

<http://cdm.csbsju.edu/cdm/ref/collection/CSBArchNews/id/2051>

1972 aerial photo of CSB

<http://cdm.csbsju.edu/cdm/ref/collection/CSBArchives/id/13>



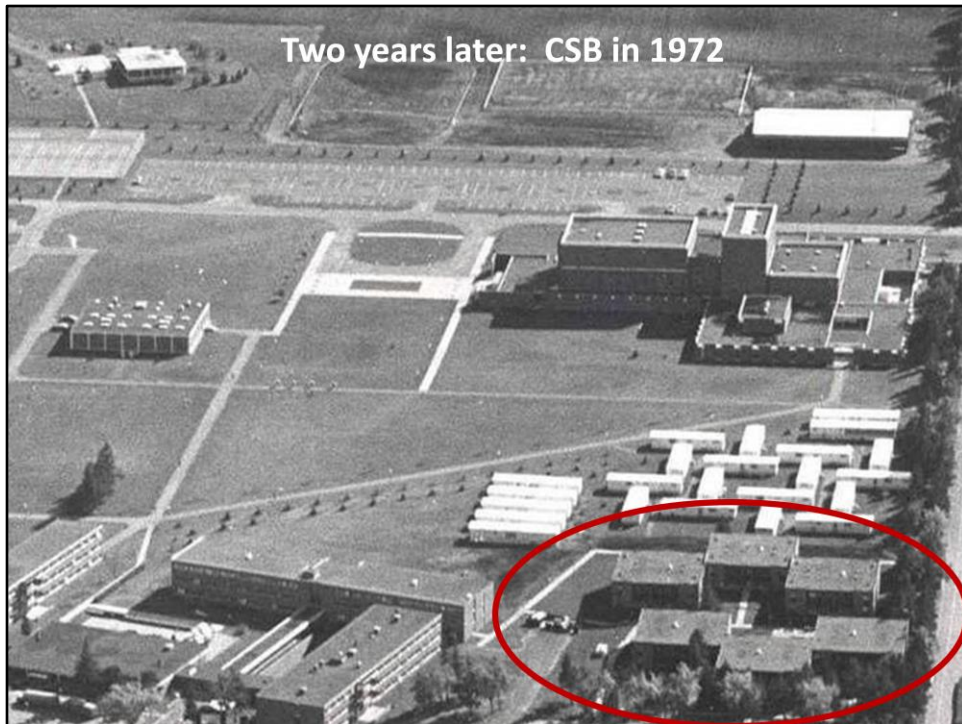

2. The West Apartments open in 1972 to help alleviate the housing crunch  
1972 aerial photo of CSB  
<http://cdm.csbsju.edu/cdm/ref/collection/CSBArchives/id/13>



**The Torch,  
Dec. 18,  
1971,  
p. 3**

### Moving In Before Christmas - Apartment Complex Nears Completion

**Mary Kay Melcher**  
In tackling the problem of living space this year St. Ben's has nearly doubled its anticipated apartment-type living areas.

In November of 1970 the trustees and committee planned the building of two new apartment complexes, having previously polled the student body in deciding between new dorms or apartments. However last spring the Federal government loan "machinery" slowed down the construction of the first complex of apartments.

In order to house the overflow of students, the school purchased 18 mobile homes which it intends to use over a three or four-year period.

Progress on the new apartment complex is only a few days from being on schedule. The first of three buildings was completed just after Dec. 1.

The new complex contains 24 apartment units. The three buildings each contain 8 apartments, four women per apartment. Each air-conditioned unit contains, as do the mobile homes, a kitchen, living-dining room, 2 bedrooms, and a bathroom. There are community and utility areas in the basements of each building. (The floor plans and the 3 color schemes are on display in the Commons.) Rent per person is a little over \$55 per month. (Mobile home rent is \$50 per month.)

Because of a complication in switching the apartments from private to federal funding, there may be a delay in actual living in the apartments.

There might not be a need in the near future for the second planned apartment complex since the school now owns the mobile homes. Its construction will depend on the enrollment projections and enrollment in the immediate future. "We are trying to determine what the ideal enrollment is for our philosophy of education. The resulting projection will show us whether or not we will have any housing problems," said Sister Mary Mark. The currently proposed maximum enrollment is approximately 1,025 students.



The West Apartments are finished, to replace the Trailers...supposedly...but the trailers house students from 1971-1975

*The Torch*, December 18, 1971. p. 3.

<http://cdm.csbsju.edu/cdm/ref/collection/CSBArchNews/id/119>

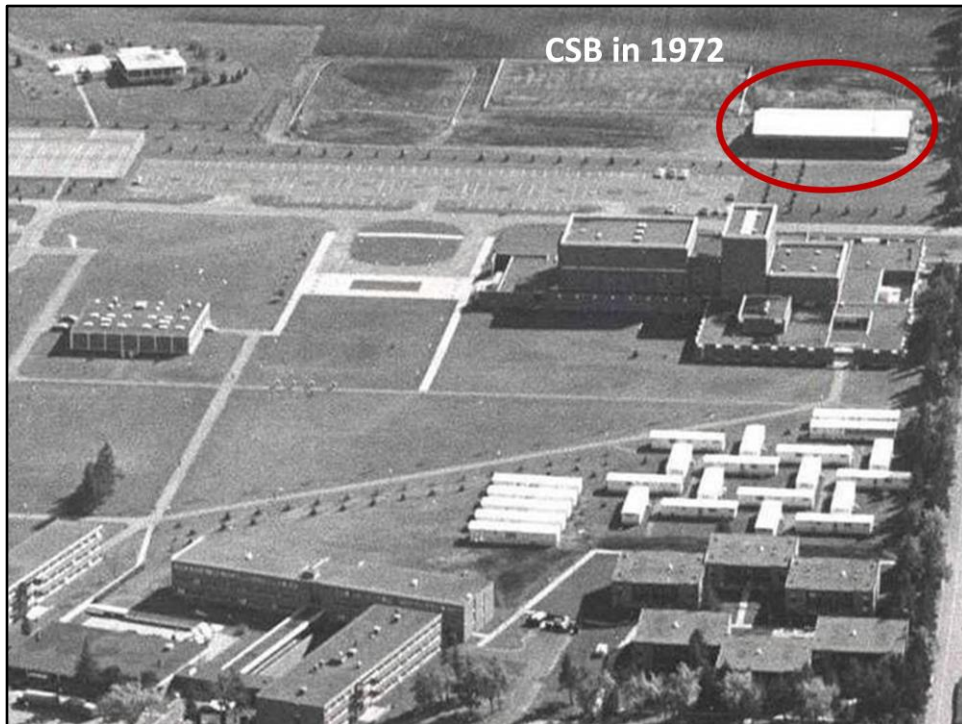

### 3. The Horse Barn

1974 May 16 *Vitae* p. 2

<http://cdm.csbsju.edu/cdm/ref/collection/CSBArchNews/id/2051>

1972 aerial photo of CSB

<http://cdm.csbsju.edu/cdm/ref/collection/CSBArchives/id/13>



3. CSB adds a Horsemanship Program and builds a barn, stables and paddocks in 1972

**CSB's campus map in 1973 includes  
a new building under construction**

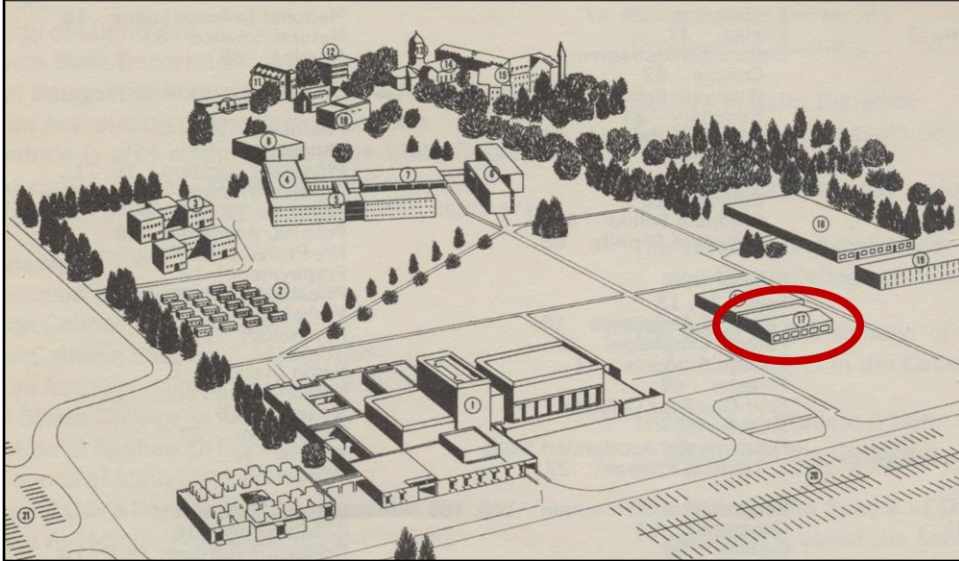

Campus map from the 1972-73 course catalog



**CSB gets a pool in 1973**



In Dec.1972, CSB President Idzerda and Mother Henrita break ground for CSB's pool, which is completed in 1973



...and becomes the "HAB"



Also in 1973: St. Ben's High School closes

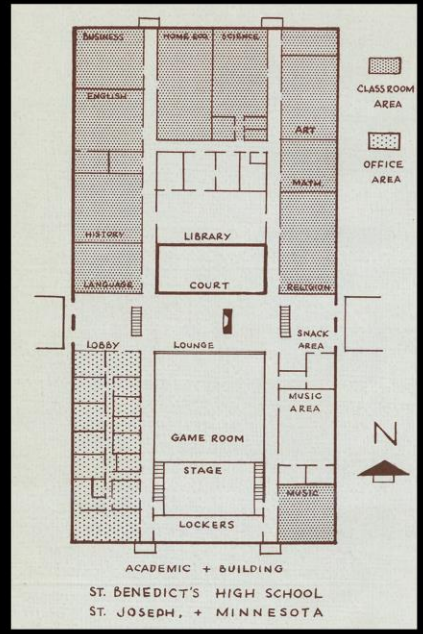

St. Ben's High School closes; the Henrita Academic Building is used by CSB

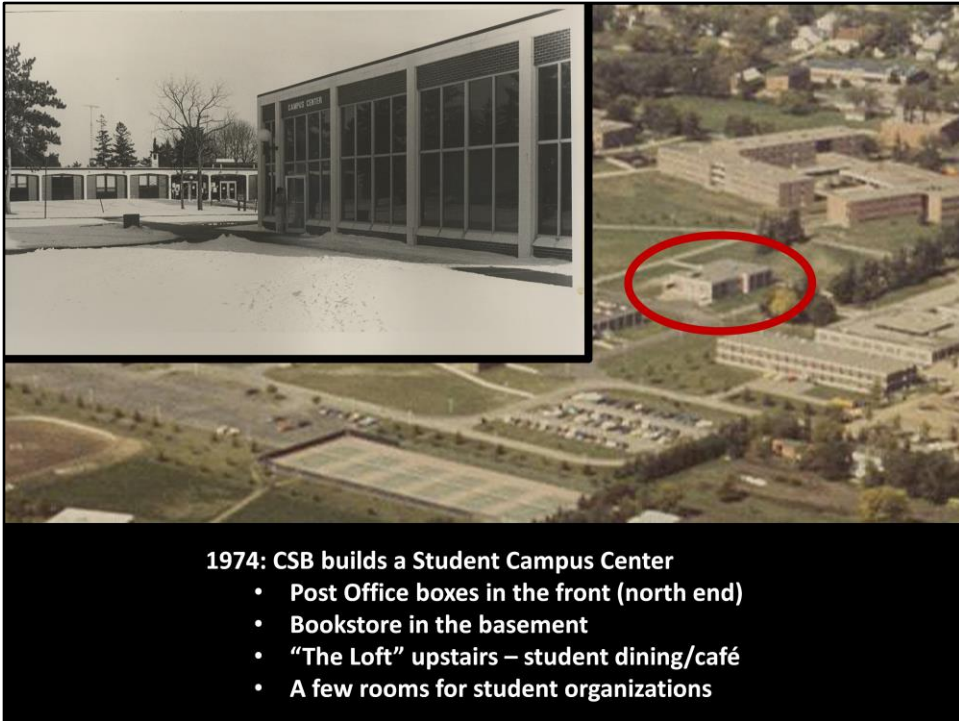

1974: CSB builds a Campus Center

**CSB's new Campus Center fills in the "Tundra" ... a bit**



1974: CSB's new Campus Center fills in a bit of the "Tundra" and houses the Bookstore (downstairs), student post office, and "The Loft" (upstairs), a campus eatery

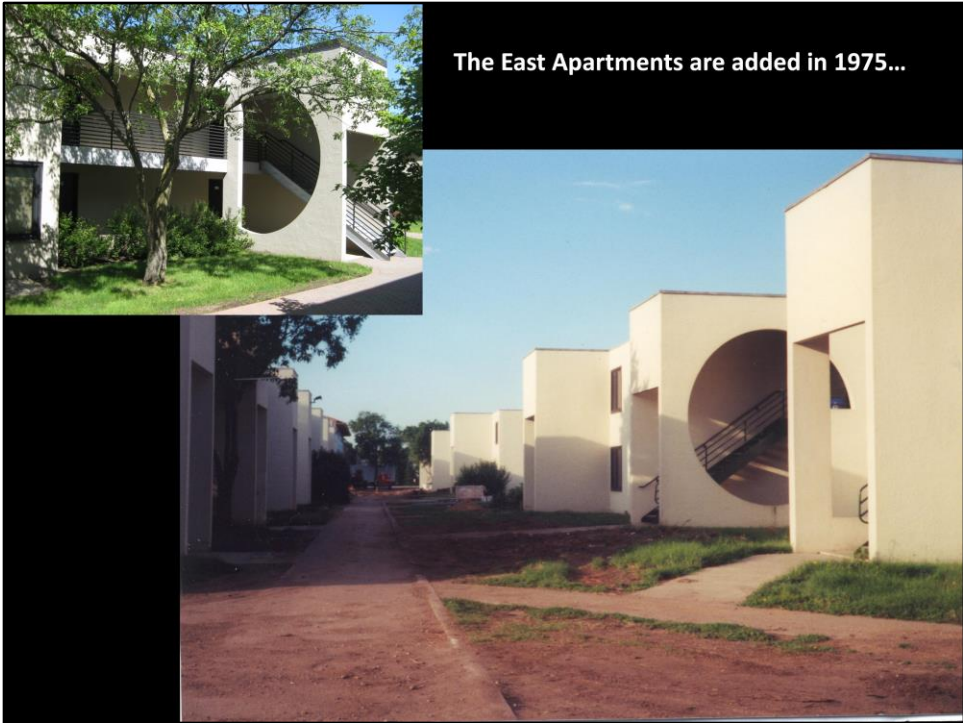

The East Apartments are added in 1975



... and the trailers are removed



CSB in 1975

Still a lot of "Tundra" out there!

1975: The trailers are removed, and there's still a lot of "Tundra"!

**1974:  
Dr. Beverly Miller  
replaces Stan Idzerda  
and serves as  
CSB President  
until 1979  
- and nothing (else) gets built for a while.**

1974: Dr. Beverly Miller replaces Stan Idzerda and serves as CSB President until 1979 - and nothing (else) gets built.



1980: Dominica is added as a 7<sup>th</sup> West Apartment

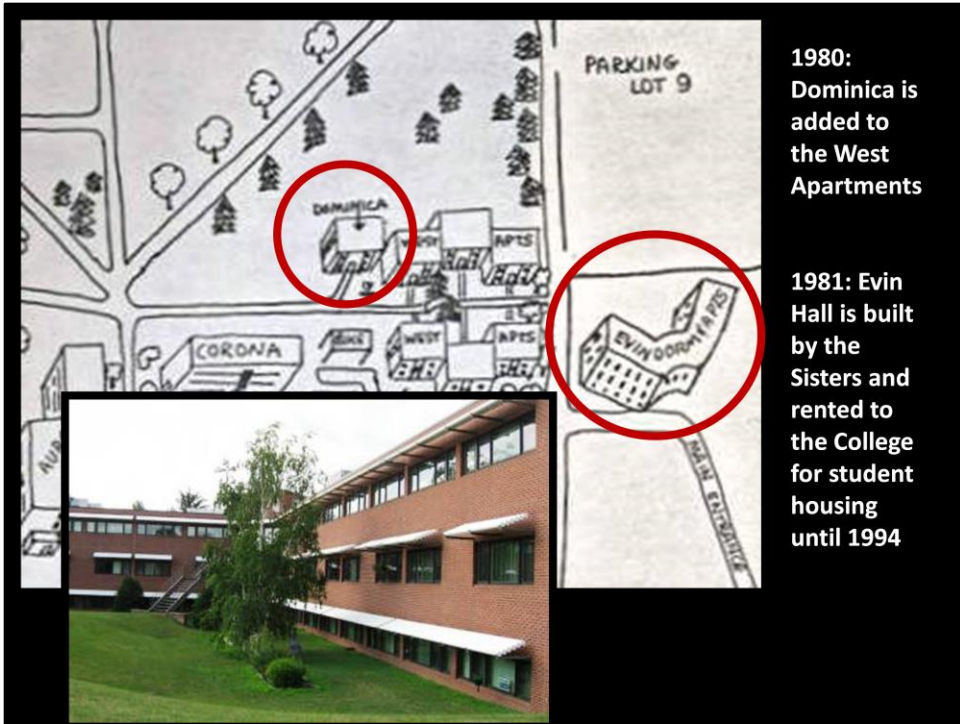

1980:  
Dominica is  
added to  
the West  
Apartments

1981: Evin  
Hall is built  
by the  
Sisters and  
rented to  
the College  
for student  
housing  
until 1994

1980-1981 Dominica Apartment & Evin Hall are added

1981 campus map <http://cdm.csbsju.edu/cdm/ref/collection/CSBArchives/id/1917>

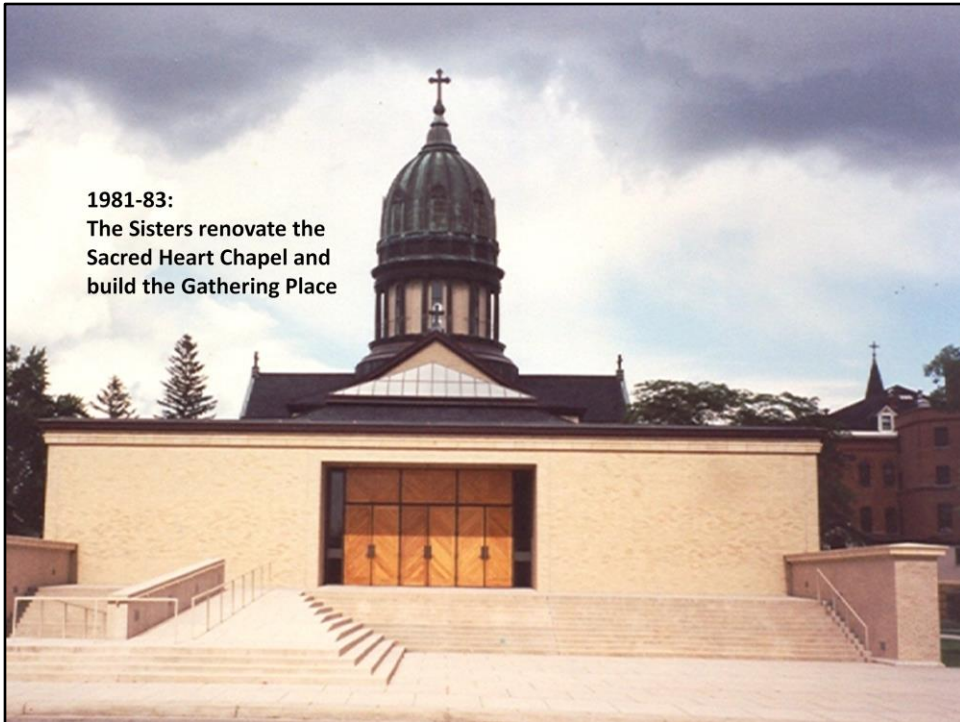

**1981-83:**  
The Sisters renovate the  
Sacred Heart Chapel and  
build the Gathering Place

1981-83: The Sisters renovate the Sacred Heart Chapel



# The Cable

College of St. Benedict

Volume 8, Number 5

30 November, 1983

## LIBRARY HAS PRIORITY OVER GYM

by Jane Merickel

The President of CSB and the presidential staff feel that sports enhance student life but the new library is the first priority over indoor athletic facilities.

Sister Emmanuel Renner, Ph.D., president, said it's important to participate in sports for reasons of health, handling stress, and coordination for a student in studies—Emmanuel walks two miles a day. Sister Coleman O'Connell, Ph.D., director of planning, says, "I don't want women in sports to feel unloved there isn't a one [administrative person] who speaks lightly of sports, it's a way to gain self-esteem as men have." Sister Coleman is known to be an early morning jogger.

Chuck Villette, Ph.D., academic dean, who believes physical activity has great significance, said that sports and academics are of equal importance; physical activity promotes well-being, mentally and physically—here needs to be a proper balance. Mike Ryan, M.S., director of college relations, says sports are especially important to a women's college. "Drive by St. Ben's any given day and it's possible to see 20 women running," said Ryan. "Women in sports are as acceptable as men right now."



(Top) Sister Emmanuel Renner  
(Bottom) Sister Coleman O'Connell  
Photo by Jane Merickel

Sister Coleman points out that we do have tennis, softball, rugby, swimming and that we are getting a two mile exercise track in the spring. But what we don't have is an adequate gymnasium. "We could emphasize these sports as we wait for indoor athletic facilities," said Coleman.

According to Coleman, CSB grew fast — we have as many students now as we had in total from 1913-1970. We built the gym before the women's movement began, when ladies didn't exercise. But as soon as the movement took hold, our gym was inadequate. In order to have a first rate institution, we had to invest in faculty. "Now the central mission of the college is the library. We have to make choices," said Coleman. "This is not a jock school; we want sports, but they have to be secondary. When the library is purchased, we'll increase sports facilities."

"I hesitate to put priority on inter-collegiate sports because intramurals lets everybody play," said Emmanuel. "Sports isn't everything, it's something to be integrated." According to Emmanuel, our first priority as a liberal arts college is academic—the library. Adequate physical space is one of CSB's major ten year goals. According to Villette, the plan for the gym will probably be component style, building piece by piece.

Villette and Chuck Dewey, assistant to the director of public information, have sent a letter to faculty and staff to come to the opening game of the CSB Blazer basketball team at Rat Hall, Dec. 1

Villette cont. page 4

1983:  
Planning for a new  
library has begun

...but, as S. Colman  
notes,

"We built the gym  
before the women's  
movement began,  
when ladies didn't  
exercise. But as  
soon as the  
movement took  
hold, our gym was  
inadequate."

1983: Planning for a new library has begun

"Library has priority over gym," Jane Merickel, Nov. 30, 1983, p. 1 *The Cable*

<http://cdm.csbsju.edu/cdm/ref/collection/CSBArchNews/id/1152/show/1148>

**ST. BEN'S BUILDS NEW GYM**

by Julie Michels

The urgent need for adequate athletic and social space at St. Ben's will finally be met this summer with the construction of a new gym. This new gym will be attached to the present gym and will be regulation-size, approximately 13,000 square feet, with seating for 500-800 fans.

The construction of the new gym was just recently approved by the St. Ben's Board of Trustees. If all goes well, ground-breaking will occur this spring and the facility will be completed by next November. Funding for the project is not coming from the Capital Campaign drive which is raising money for the construction of the new library. Rather, the funds are coming from the college's reserve fund.

This new facility will obviously receive a warm welcome from the many intercollegiate teams at St. Ben's. For the past two years the CSB basketball team has had to hold its home games at St. John's Rat Hall. Since St. John's cannot guarantee usage of Rat Hall for the basketball games after this year, the new gym will solve many problems for this team. Volleyball coach and Phys. Ed. instructor Margo Coleman said that, although the gym will not be completed in time for volleyball season, she is "excited about it (the new gym) because it shows a strong commitment on the part of the administration to have a strong athletic program." Other intercollegiate teams not traditionally billed as "indoor sports" (soccer, softball, rugby, tennis) will also now be able to practice indoors if the need arises.

Those not involved in intercollegiate sports can also make use of the new gym by participating in intramural sports. This program will undoubtedly be expanded and will hopefully motivate women on campus to get involved.

Despite the many athletic advantages of the new gym, the birth of the new social space will probably have the greatest effect on present and prospective St. Ben's students. Now St. Ben's will be able to host many of the social activities before held only at St. John's. Missy Young, junior JEC and SAB member, states "It's exciting to know

Its regulation size facilitates CSB's entry into MIAC (MN Athletic Conference)

*The Cable*

1984: Groundbreaking for a new gym  
 1984 March 15 P. 1 *The Cable* "St. Ben's Builds New Gym" by Julie Michels  
<http://cdm.csbsju.edu/cdm/ref/collection/CSBArchNews/id/1264>

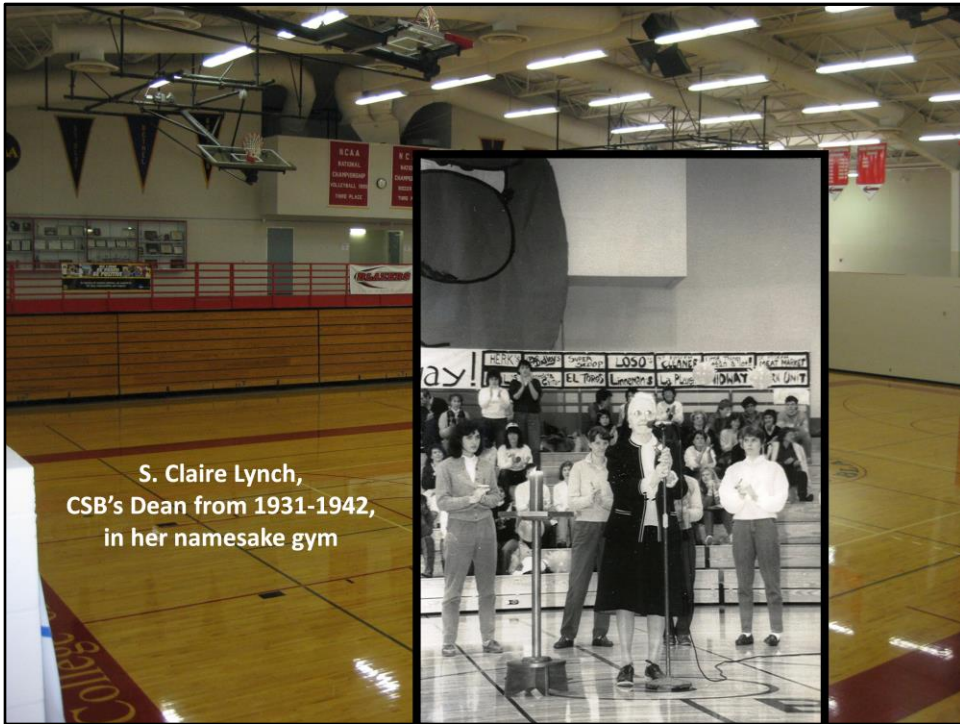

S. Claire Lynch, CSB's Dean from 1931-1942, in her namesake gym  
The construction of the gym was done before the much needed library due to the availability of college reserve funds.

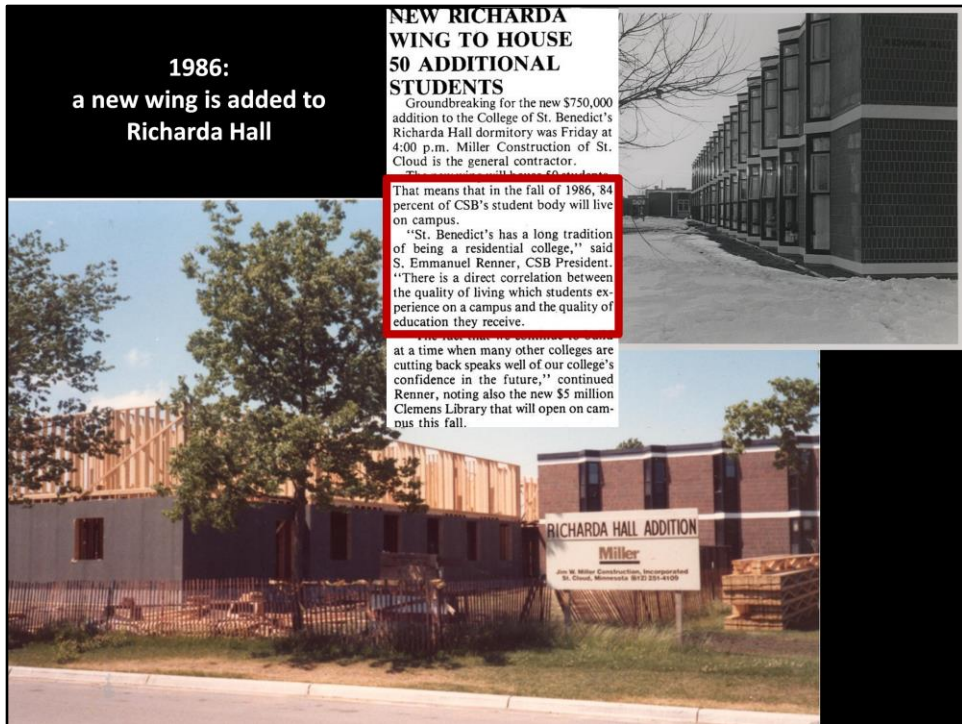

1986 – a new wing is added to Richarda Hall (formerly the high school dorm)  
 1986 April 18, p. 7 *The Cable*  
<http://cdm.csbsju.edu/cdm/ref/collection/CSBArchNews/id/1500/show/1490>



1985: Library construction is underway





Photo from St. Ben's Monastery Archives

**In 1986, the “Tundra” has shrunk a bit!**



**The Library's dedication milestone marks a major accomplishment of S. Emmanuel's presidency and the beginning of S. Colman's presidency**

With the completion of the library, there is less of the “Tundra.”  
<http://cdm.csbsju.edu/cdm/ref/collection/CSBArchives/id/15>

# CSB'S CLEMENS LIBRARY A HIT

Some spots are great for scoping and scamming...others are great for serious studying.

Studying? On the beach? No, this isn't the washed out monastery beach of the Sag, it's the new Clemens Library, and it's a big hit for some people you might know, and maybe even for you.



too specific, because this was the first time that he's been in. But he did mention that he didn't much care for the bean bags.



So what does Clemens have to offer besides computers, bean bags, scoping, and serious study space? About 55,000 feet of floor space, and room to seat 600. Plus, there is stack space for 200,000 volumes. Current holdings include 130,000 volumes. The architect's design anticipated a shift from print to electronic media, so Clemens will be technically up to date for a long time into the future. One



Mark Grathje busy at Clemens.



nice feature in the architect's design was the provision for a second tier of stack ranges, enabling the library to double its holdings without requiring an addition to the building.

Kathleen Borasch, Pickle Gillasch, and Mark Bortscheller were all impressed by the comfortable chairs. They thought that the library was a definite asset to both colleges. Kathy added that it was nice to have indirect lighting, because it was easier to study with.

Patty Rys, a junior at CSB, does most of her studying in the library and said that the new

## "CSB's Clemens Library a Hit"

1986 Oct. 10 p. 1 *The Cable*

<http://cdm.csbsju.edu/cdm/ref/collection/CSBArchNews/id/1643>

**1987:  
Clemens Library  
gets its bells**



**The bell tower is reminiscent of  
the bell tower in Eichstatt, Bavaria**

1987: Clemens Library gets its bells



1988

Margretta Hall  
opens for  
sophomores,  
named in honor of  
S. Margretta Nathe

1988 – Margretta Hall opens, named in honor of S. Margretta Nathe, OSB  
(Eight years later, Brian Hall opens in honor of S. Brian Spain, pictured at right with S. Margretta)



# Students enjoy the comforts of Margretta "Hotel"

by Julie Martinka

The Benedictan value of hospitality shines through in the newest addition to the College of St. Benedict campus, Margretta Hall.

The new dorm is comparable to the lobby of a hotel or a condominium complex. High ceilings and wide hallways give it a very spacious and clean atmosphere. Housing 157 students, this dorm consists of 68 double rooms and 21 singles, six of which have private baths. The entire dorm is also air conditioned.

Due to the dorm's original architectural structure, the rooms are of all shapes and sizes. Residents

Each of the three floors have a computer room containing four computers, a study room, and a spacious lounge with a television. There is a conference room on the bottom floor which is also being used for aerobic classes. This room is connected to a kitchen which has two stoves, a double sink, lots of cupboard and counter space, and a microwave.

When asked if the residents had any concerns or criticisms about their new dorm, they replied, "Are you kidding? What more could you ask for?"

There were a few comments made about the location. Some of the residents feel isolated but the majority



photo by Brenda Schindler

The original architecture of Margretta Hall makes each room unique.

and the blinds were just being put in last week. One resident commented that it was definitely worth the wait. Margretta Hall is bursting with student activity and is beginning to take on a comfortable and lived in feeling. There's no place like home in Margretta Hall.



"What more could you ask for?"

"There's no place like home in Margretta Hall"

1988: Margretta Hall is a big hit





**1988-90:  
Teresa Hall is  
remodeled,  
inside & out.**



1988-90: Teresa Hall is remodeled, inside and out.  
The old library becomes the TRC (Teresa Reception Center), on the first floor



The old library becomes the TRC (Teresa Reception Center), on the first floor

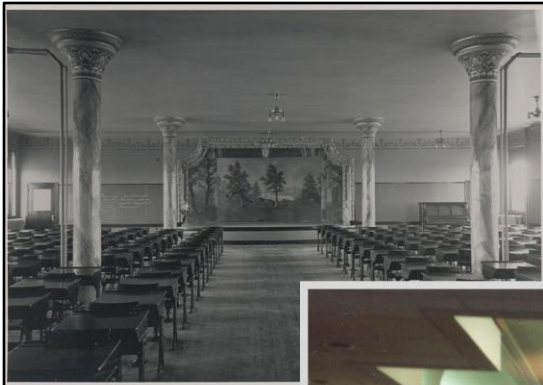

**The old auditorium**

**has become the  
CSB Business Office**



The old auditorium has become the Business Office on 2<sup>nd</sup> floor

The old metal fire escape staircase

is replaced by an internal one on the northwest side



The old metal fire escape stairway is replaced with interior stairs





The staircase at the "knuckle" is enclosed, decades after its porticos gained windows.

Left photo from 1945 *Facula*, p. 1

<http://cdm.csbsju.edu/cdm/ref/collection/CSBArchives/id/3303/show/3262>

B&W group photo from O:\Photos\CSB photos from SBMA\COLLEGE\760College.jpg

Color photo O:\Photos\Buildings Photos\Main Building\Main Exterior 1970s-90s\Main (Oct.1996) 001



Even the Fish Pond gets a facelift!





Compiled in November/December 2012 from resources in the  
CSB Archives and the St. Ben's Monastery Digital Archives  
by Peggy Landwehr Roske, CSB/SJU Archivist.  
All rights reserved.

#### Credits

Aerial photo 1989 <http://cdm.csbsju.edu/cdm/ref/collection/CSBArchives/id/17>